



Inspection Chamber PRO 630 Product Guide

Pipelife Inspection Chamber PRO 630

QUALITY FLEXIBILITY TIME

- Unique Pipelife ADAPTER FUSE technology provides „any angle, any size, any height“ inspection chamber inlets / outlet for the major sewer pipe types in dimensions 160, 200, 250, 315 and 400 mm.
- Pipelife PRO FLOW CHANNEL SHELL concept provides custom made inlet / outlet 100% flexible configuration each 1°.
- PRO 630 is produced in local Pipelife PRO DEPO. This concept guarantees shortest delivery time for all standard or custom made chambers.
- PRO 630 is designed for installations under high ground water level conditions in up to 6 m depth. The complete tightness of joints and welds was observed during PRO 630 1000 h pressure test with negative and positive pressure of more than 0.5 bar under different temperatures.
- PRO 630 all gasket socket / spigot connections are 100% tight, designed and tested according to EN 1277 and EN 476.
- PRO 630 Base ST inlets / outlet angle could be customized with $\pm 7.5^\circ$ Adjustable Double Socket.
- PRO 630 PP Base in combination with standard PP Double Wall pipe OD 630 mm as the riser shaft and floating PP Telescope Pipe or Concrete ring, designed to fit all the major cast iron or concrete cover frames, has high resistance to heavy traffic loads and could be installed on any municipal or private sewer main line.
- PRO 630 parts are light weight products, easy to transport and to install.
- PRO 630 is designed for High Pressure Water Jetting equipment and easy access with CCTV camera into sewer line as well as slope grade laser level.

PRO 630 Components



PRO 630 complete set

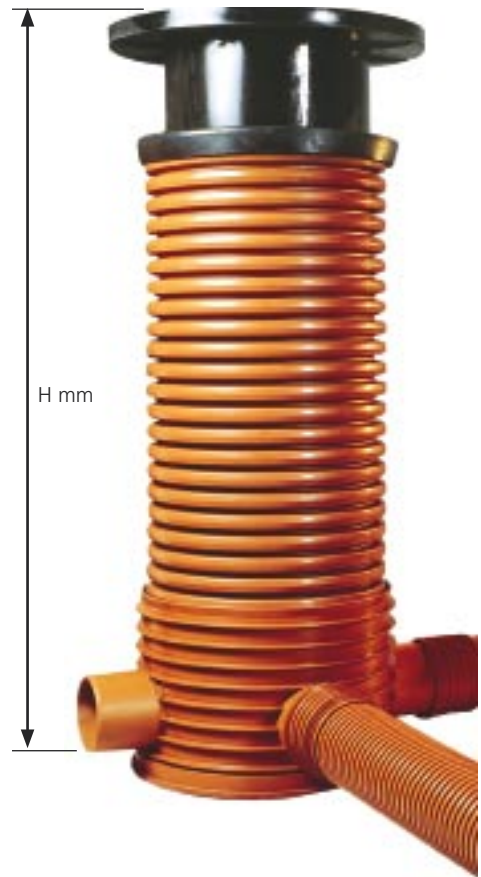

H= effective height PRO 630 (excluding cast iron frame and cover)

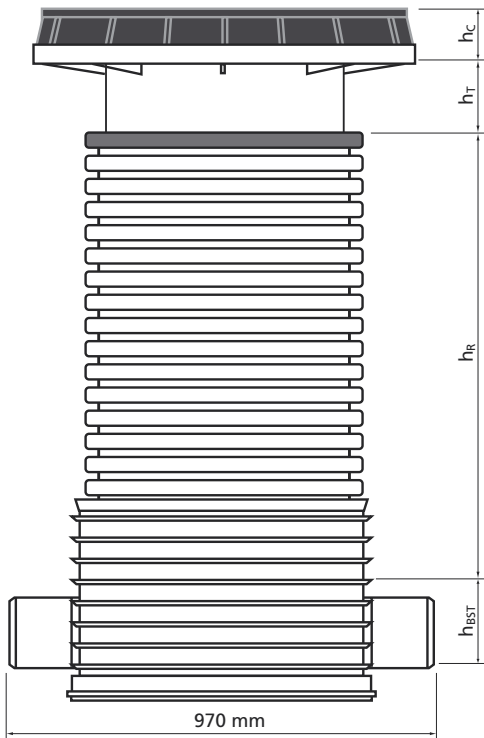

Cast Iron Frame & Cover

Telescope Pipe Concrete Ring

Riser Pipe

Base ST Base ML

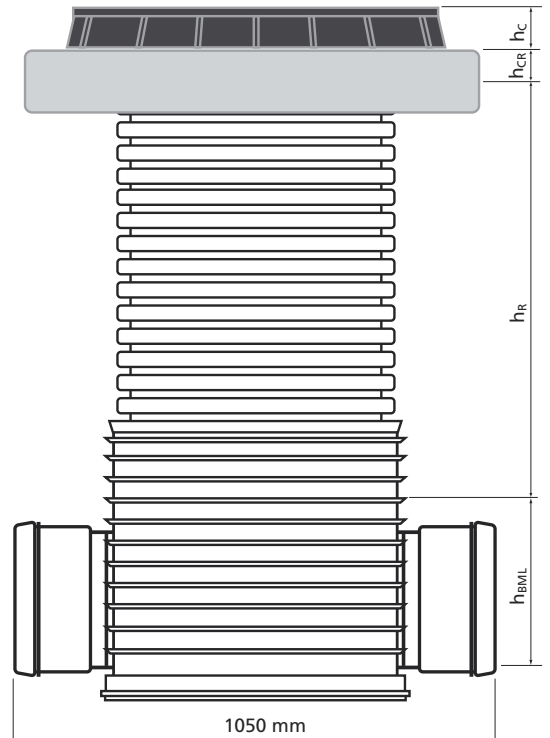

Straight Through Bases* with side inlets

Base ST

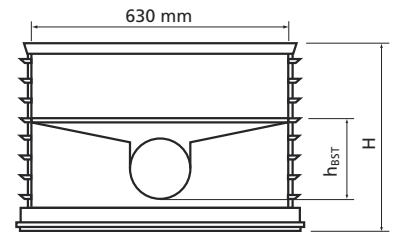

0° / 180°

Article Nr.	Inlet / Outlet OD mm	Base Height H mm	Effective Height h _{BST} mm
616000000	160	466	200
620000000	200	466	200

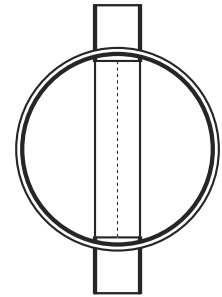

0° / 90° / 180°

Article Nr.	Inlet / Outlet OD mm	Base Height H mm	Effective Height h _{BST} mm
616090000	160	466	200
620090000	200	466	200

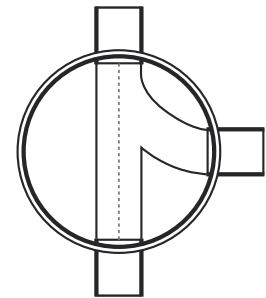

0° / 90° / 180° / 225°

Article Nr.	Inlet / Outlet OD mm	Base Height H mm	Effective Height h _{BST} mm
616090225	160	466	200
620090225	200	466	200

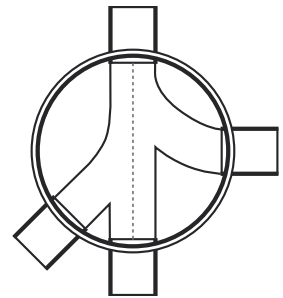

0° / 90° / 180° / 270°

Article Nr.	Inlet / Outlet OD mm	Base Height H mm	Effective Height h _{BST} mm
616090270	160	466	200
620090270	200	466	200

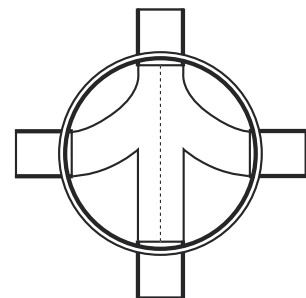

* Straight Through Base inlets/outlet have spigot ends.
 For fixed angle connection use standard Single (smooth) Wall (SW) pipe double socket or Double Wall (DW) pipe double socket with a click ring and a sealing ring. For uncertain angle connection use 7.5° ADJUSTABLE DOUBLE SOCKET.

Base ST

Straight Through Bases with side inlets

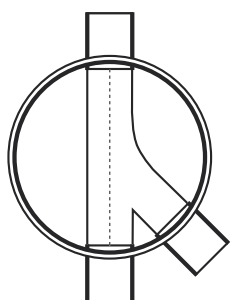

0° / 135° / 180°

Article Nr.	Inlet / Outlet OD mm	Base Height H mm	Effective Height h_{BST} mm
616135000	160	466	200
620135000	200	466	200

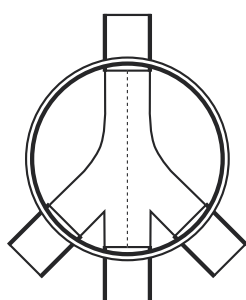

0° / 135° / 180° / 225°

Article Nr.	Inlet / Outlet OD mm	Base Height H mm	Effective Height h_{BST} mm
616135225	160	466	200
620135225	200	466	200

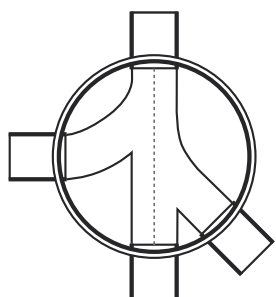

0° / 135° / 180° / 270°

Article Nr.	Inlet / Outlet OD mm	Base Height H mm	Effective Height h_{BST} mm
616135270	160	466	200
620135270	200	466	200

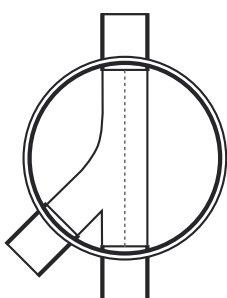

0° / 180° / 225°

Article Nr.	Inlet / Outlet OD mm	Base Height H mm	Effective Height h_{BST} mm
616000225	160	466	200
620000225	200	466	200

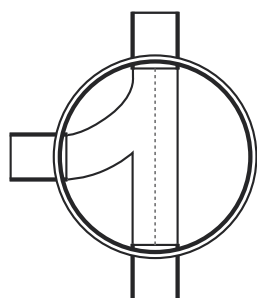

0° / 180° / 270°

Article Nr.	Inlet / Outlet OD mm	Base Height H mm	Effective Height h_{BST} mm
616000270	160	466	200
620000270	200	466	200

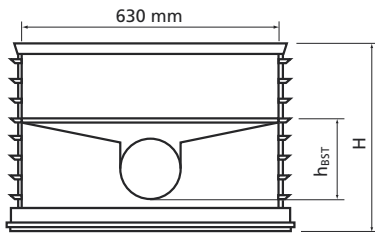

**Base ST SO
Special Order
Inlets / Outlet OD 160 mm**

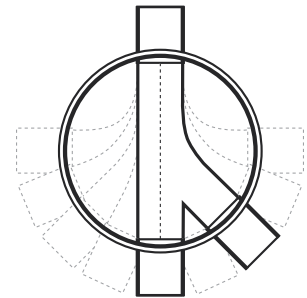

Article Nr.	Description	Base Height H mm	Effective Height h_{BST} mm	
			main in/out*	side inlets**
616105000	0° / 105° / 180°	466	200	150
616105225	0° / 105° / 180° / 225°	466	200	150
616105270	0° / 105° / 180° / 270°	466	200	150
616120000	0° / 120° / 180°	466	200	150
616120225	0° / 120° / 180° / 225°	466	200	150
616120270	0° / 120° / 180° / 270°	466	200	150
616150000	0° / 150° / 180°	466	200	150
616150225	0° / 150° / 180° / 225°	466	200	150
616150270	0° / 150° / 180° / 270°	466	200	150
616165000	0° / 165°	466	200	–
616165225	0° / 165° / 225°	466	200	150
616165270	0° / 165° / 270°	466	200	150
616090195	0° / 90° / 195°	466	200	150
616135195	0° / 135° / 195°	466	200	150
616000195	0° / 195°	466	200	–
616090210	0° / 90° / 180° / 210°	466	200	150
616135210	0° / 135° / 180° / 210°	466	200	150
616000210	0° / 180° / 210°	466	200	150
616090240	0° / 90° / 180° / 240°	466	200	150
616135240	0° / 135° / 180° / 240°	466	200	150
616000240	0° / 180° / 240°	466	200	150
616090255	0° / 90° / 180° / 255°	466	200	150
616135255	0° / 135° / 180° / 255°	466	200	150
616000255	0° / 180° / 255°	466	200	150

* main inlet 165°, 180°, 195°, outlet 0°

** side inlet 105°, 120°, 150°, 210°, 240°, 255°

Base ST

Straight Through Bases with side inlets

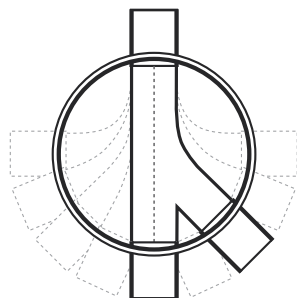
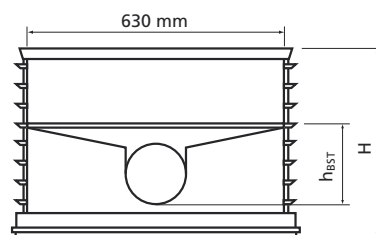

Base ST SO Special Order Inlets / Outlet OD 200 mm

Article Nr.	Description	Base Height H mm	Effective Height h_{BST} mm	
			main in/out*	side inlets**
620105000	0° / 105° / 180°	466	200	185
620105225	0° / 105° / 180° / 225°	466	200	185
620105270	0° / 105° / 180° / 270°	466	200	185
620120000	0° / 120° / 180°	466	200	185
620120225	0° / 120° / 180° / 225°	466	200	185
620120270	0° / 120° / 180° / 270°	466	200	185
620150000	0° / 150°	466	200	–
620150225	0° / 150° / 225°	466	200	185
620150270	0° / 150° / 270°	466	200	185
620165000	0° / 165°	466	200	–
620165225	0° / 165° / 225°	466	200	185
620165270	0° / 165° / 270°	466	200	185
620090195	0° / 90° / 195°	466	200	185
620135195	0° / 135° / 195°	466	200	185
620000195	0° / 195°	466	200	–
620090210	0° / 90° / 210°	466	200	185
620135210	0° / 135° / 210°	466	200	185
620000210	0° / 210°	466	200	–
620090240	0° / 90° / 180° / 240°	466	200	185
620135240	0° / 135° / 180° / 240°	466	200	185
620000240	0° / 180° / 240°	466	200	185
620090255	0° / 90° / 180° / 255°	466	200	185
620135255	0° / 135° / 180° / 255°	466	200	185
620000255	0° / 180° / 255°	466	200	185

* main inlet 150°, 165°, 180°, 195°, 210°, outlet 0°
 ** side inlet 105°, 120°, 240°, 255°

Base ST inlet / outlet connections

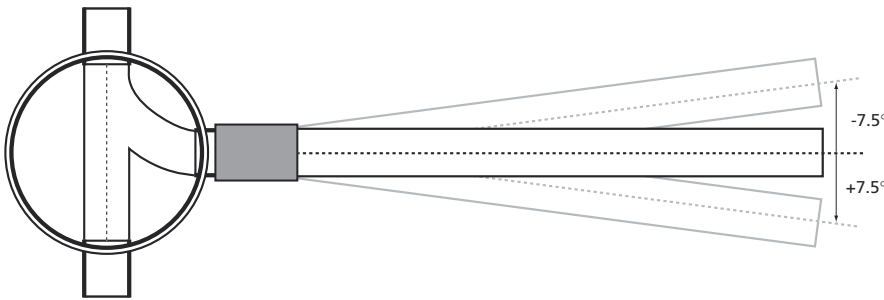

7.5° adjustable double socket for SW pipes

Article Nr.	Size mm	Description
6STADS160	160	ADS allows to change inlet / outlet angle 7.5°
6STADS200	200	ADS allows to change inlet / outlet angle 7.5°



Standard double socket for SW pipes

Article Nr.	Size mm	Description
6STSDS160	160	for Base ST use with SW smooth pipes
6STSDS200	200	for Base ST use with SW smooth pipes



PP DW Pragma double socket

Article Nr.	Size mm	Description
6STPDS160	160	for Base ST use with DW corrugated pipes
6STPDS200	200	for Base ST use with DW corrugated pipes



PP DW Pragma double socket click ring and sealing ring

Article Nr.	Size mm	Description
6STCRS160	160	for PP DW double socket / spigot connection
6STCRS200	200	for PP DW double socket / spigot connection



PP DW Pragma spigot adapter

Article Nr.	Size mm	Description
6STPSA160	160	for PP DW pipe connection to ADS or standard double socket
6STPSA200	200	for PP DW pipe connection to ADS or standard double socket



Base ML Main Line Bases* with optional extra inlets

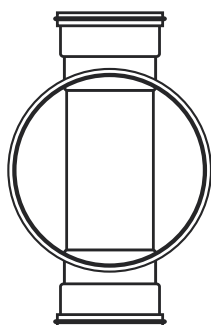
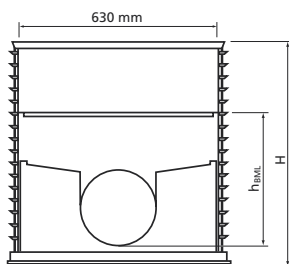

0° / 180°

Article Nr.	Inlet / Outlet OD mm	Base Height H mm	Effective Height h _{BML} mm
625000180	250	613	350
631000180	315	613	350
640000180	400	766	500

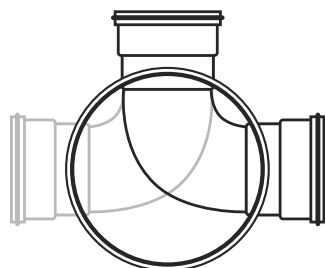

0° / 90° or 0° / 270°

Article Nr.	Inlet / Outlet OD mm	Base Height H mm	Effective Height h _{BML} mm
625000090	250	613	350
631000090	315	613	350

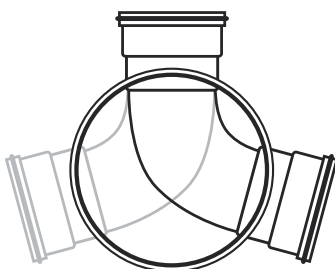

0° / 105° or 0° / 255°

Article Nr.	Inlet / Outlet OD mm	Base Height H mm	Effective Height h _{BML} mm
625000105	250	613	350
631000105	315	613	350



0° / 120° or 0° / 240°

Article Nr.	Inlet / Outlet OD mm	Base Height H mm	Effective Height h _{BML} mm
625000120	250	613	350
631000120	315	613	350

* Main Line Base inlets/outlet have integrated socket for Double Wall (DW) pipes. For ML Base use on Single (smooth) Wall (SW) pipe mainline a click ring and a sealing ring should be installed on each inlet/outlet socket.

Main Line Bases with optional extra inlets

Base ML

0° / 135° or 0° / 225°

Article Nr.	Inlet / Outlet OD mm	Base Height H mm	Effective Height h_{BML} mm
625000135	250	613	350
631000135	315	613	350
640000135	400	766	500



0° / 150° or 0° / 210°

Article Nr.	Inlet / Outlet OD mm	Base Height H mm	Effective Height h_{BML} mm
625000150	250	613	350
631000150	315	613	350

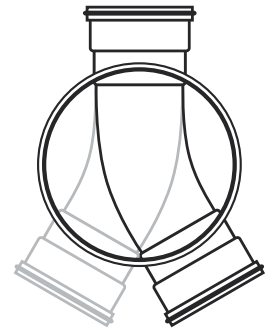

0° / 165° or 0° / 195°

Article Nr.	Inlet / Outlet OD mm	Base Height H mm	Effective Height h_{BML} mm
625000165	250	613	350
631000165	315	613	350

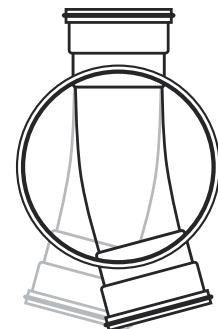

Base ML optional extra inlets

Article Nr.	Inlet / Outlet OD mm	Effective Height h_{BML} mm
6FMLAI160	160	250
6FMLAI200	200	250
6FMLAI250	250	250
6FMLAI315	315	300



Base ML SO

Main Line Bases with optional extra inlets

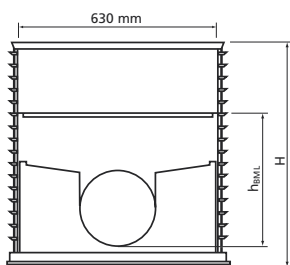

Base ML SO Special Order Inlet / Outlet socket 250 mm

Article Nr.	Description	Base Height H mm	Effective Height h_{BML} mm
625000095	0° / 95° or 0° / 265°	613	350
625000100	0° / 100° or 0° / 260°	613	350
625000110	0° / 110° or 0° / 250°	613	350
625000115	0° / 115° or 0° / 245°	613	350
625000125	0° / 125° or 0° / 235°	613	350
625000130	0° / 130° or 0° / 230°	613	350
625000140	0° / 140° or 0° / 220°	613	350
625000145	0° / 145° or 0° / 215°	613	350
625000155	0° / 155° or 0° / 205°	613	350
625000160	0° / 160° or 0° / 200°	613	350
625000170	0° / 170° or 0° / 190°	613	350
625000175	0° / 175° or 0° / 185°	613	350

Base ML SO Special Order Inlet / Outlet socket 315 mm

Article Nr.	Description	Base Height H mm	Effective Height h_{BML} mm
631000095	0° / 95° or 0° / 265°	613	350
631000100	0° / 100° or 0° / 260°	613	350
631000110	0° / 110° or 0° / 250°	613	350
631000115	0° / 115° or 0° / 245°	613	350
631000125	0° / 125° or 0° / 235°	613	350
631000130	0° / 130° or 0° / 230°	613	350
631000140	0° / 140° or 0° / 220°	613	350
631000145	0° / 145° or 0° / 215°	613	350
631000155	0° / 155° or 0° / 205°	613	350
631000160	0° / 160° or 0° / 200°	613	350
631000170	0° / 170° or 0° / 190°	613	350
631000175	0° / 175° or 0° / 185°	613	350

Main Line Bases with optional extra inlets

Base ML SO

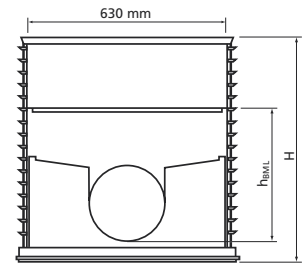

Base ML SO
Special Order
Inlet / Outlet socket 400 mm

Article Nr.	Description	Base Height H mm	Effective Height h_{BML} mm
640000140	0° / 140° or 0° / 220°	766	500
640000145	0° / 145° or 0° / 215°	766	500
640000150	0° / 150° or 0° / 210°	766	500
640000155	0° / 155° or 0° / 205°	766	500
640000160	0° / 160° or 0° / 200°	766	500
640000165	0° / 165° or 0° / 195°	766	500
640000170	0° / 170° or 0° / 190°	766	500
640000175	0° / 175° or 0° / 185°	766	500

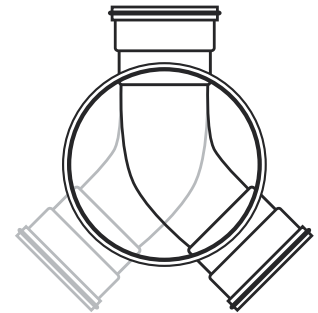

Base ML
Click Ring and Sealing Ring
for Inlet / Outlet socket

Article Nr.	Size mm	Description
6SACRS250	250	for Base ML socket use with SW pipes
6SACRS315	315	for Base ML socket use with SW pipes
6SACRS400	400	for Base ML socket use with SW pipes

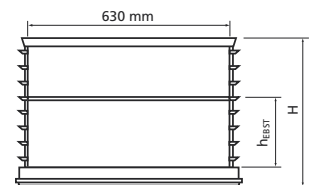

Empty Base

Article Nr.	Description	Base Height H mm	Effective Height h_{EBST} mm
6EB000000	no inlets / outlet	466	230

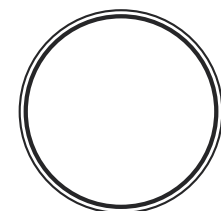

Risers and accessories

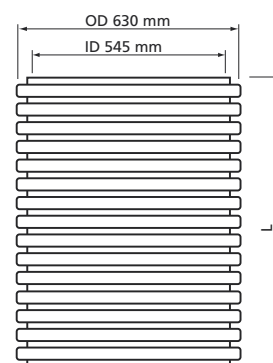

PP DW Riser pipe

Article Nr.	OD mm	L mm	Effective Height h_R mm
6R6301000	630	1000	1000
6R6301500	630	1500	1500
6R6302000	630	2000	2000
6R6306000	630	6000	6000

Riser sealing ring

Article Nr.	Size mm	Riser type
6DWRS0630	630	PP Double Wall corrugated
6SWRS0630	630	PVC Single Wall smooth

ADAPTER FUSE extra inlets

Article Nr.	OD mm	L mm	Description
6HWEI0160	160	200	Spigot end
6HWEI0200	200	200	Spigot end
6HWEI0250	250	200	Socket
6HWEI0315	315	200	Socket

CUT IN (IN SITU) rubber adapter

Article Nr.	Size mm	Riser type
6RCIRA160	160	for cut in inlet into PP DW riser
6RCIRA200	200	for cut in inlet into PP DW riser

PP Top Plug / Cover for Riser pipe

Article Nr.	Size mm	Riser type
6DWRPL630	630	PP Double Wall corrugated
6SWRPL630	630	PVC Single Wall smooth

Telescopes and Covers

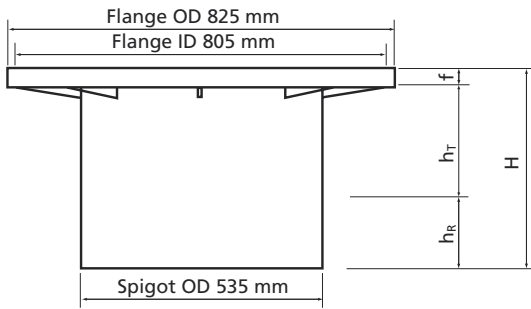

Telescope pipe with flange for standard cover

Article Nr.	Size mm	Flange f mm	Effective Height h_T mm	Inside Riser h_R mm
6TP535805	535 / 805	50	< 250	> 150



Telescope pipe with cast iron frame and cover

Article Nr.	Size mm	Description
STP500720	500 / 720	Telescope with cast iron cover 40t rated



Rubber Adapter for telescope / riser pipe

Article Nr.	Size mm	Description
6RA545535	545 / 535	for Telescope 535 / 805
6RA545500	545 / 500	for Telescope 535 / 720



Concrete ring

Article Nr.	Size mm	Height H mm	Effective Height h_{CR} mm
6CRR00630	1000 / 640	150	50



Cast iron frame and cover

Article Nr.	Size mm	Description
6CIF800600	800 / 600	Standard cast iron frame and cover 40t rated

Pipelife, a leading supplier of plastic pipe systems, is globally active in more than 26 countries.

Secure plastic pipe systems are of increasing importance for the transportation of water, other liquids and gases but also as firm cover for energy and information supply.

This is our contribution to the improvement of society – worldwide.

The variety of standards covered by our product range represents high and consistent quality of our products, and being supplied by a reliable and caring manufacturer ensures customer satisfaction.

Our customer's expectations are different and change over time. Therefore our development efforts are focused on the simplification of our customer's life.

Our experts are present in all the different markets, know the local conditions and are aware of special requirements and needs.

Our solutions are intended to reduce handling efforts, shorten installation time and improve the life of our customers and their clients.

We are willing and able to work with our customers for all the applications covered by our product range, from standard solutions for civil- and structural engineering up to tailor-made solutions for industrial purposes.

This Product Guide is intended to provide an overview of Pipelife Inspection Chamber PRO 630, designed for use in sanitary sewer and storm drain systems.

For further and more detailed information please contact our marketing team. We are glad to provide you with the optimal solution for your needs and wishes.



Pipelife International GmbH
Triester Strasse 14
A-2351 Wr. Neudorf
Phone: +43.2236.439 39.30
Fax: +43.2236.439 39.6
E-mail: fss@pipelife.com

www.pipelife.com

